

## PNEUMATIC PUNCHING MACHINES

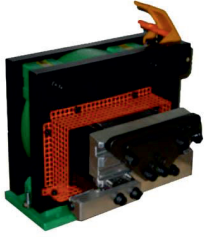

### Functions

Pneumatic punching machine designed to carry out the machining of the GIESSE cremone with C/C distance 104 mm. It also drills Ø8 mm holes in the connecting rod for the aluminum and/or polyamide Euro Groove (03524) and corners opening. Designed to be placed on any work bench or as an alternative to the 584051 base.

Online data sheet



### Technical Features

Possibility of operating the press by means of a hand lever or foot pedal.

Processing possibilities:

- Cremone with C/C distance 104 mm
- Ø8 drilling of the connecting rod for the aluminum and/or polyamide Euro Groove (03524)
- Opening of the corners for inserting hardware in the channel

104 mm C/C distance

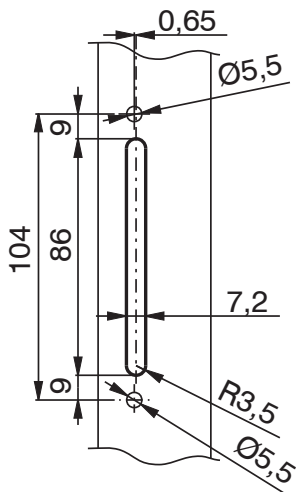

Tabs removal

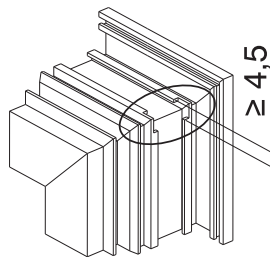

Rods drilling

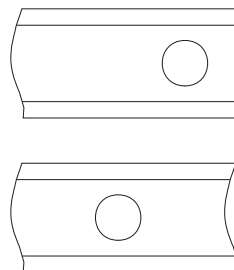

Item code	Description	Note	Base Raw	Anodised Elox	Painted	Trend/Gold Brass	Pieces per pack
5810190001	PS019 PUNCHING MACHINE	E.G.	X				1
5840510000	PS0 PUNCHING MACHINE SUPPORT BASE		X				1