

## CHIC 3D 150

**Functions**

Complete system for the construction of tilt-and-turn windows with load capacities of up to 150 kg. Available in the standard, logic and microventilation versions.

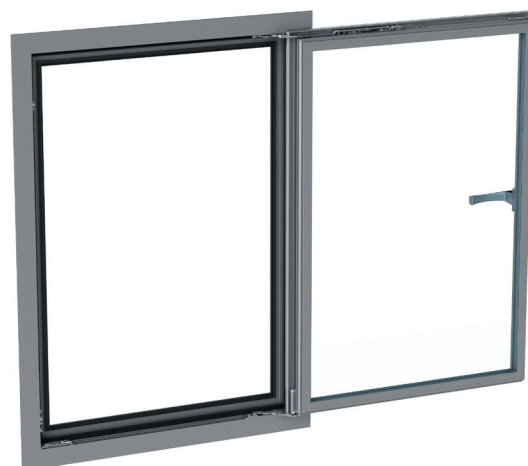

# CHIC 150

**Technical Features**

Making a CHIC 3D 150 Tilt-and-Turn mechanism requires:

1. Set of hinges + arms
2. Set of mechanisms for cremones, window handles and NP SUPRA window handles
3. Cremone, window handle or NP SUPRA window handle (available in different models to choose from in the specific catalogue section)

**Adjustments**

The adjustments are micrometric and independent.

**Standard microventilation**

Micro-ventilation enables having simultaneously both the tilt-and-turn position and micro-ventilation (precision opening of the sash) on the casement, for better air exchange.

**Logica**

The logical operation consists in first tilt-and-turn opening (with the cremone at 90°) and secondly side-hung opening (with the cremone at 180°). Its use is particularly recommended in public buildings (schools, hospitals, etc.) in combination with a cremone with a key in order to have only tilt-and-turn window opening for safety reasons and to allow full opening only for staff with the key.

Production micro-ventilation with standard opening

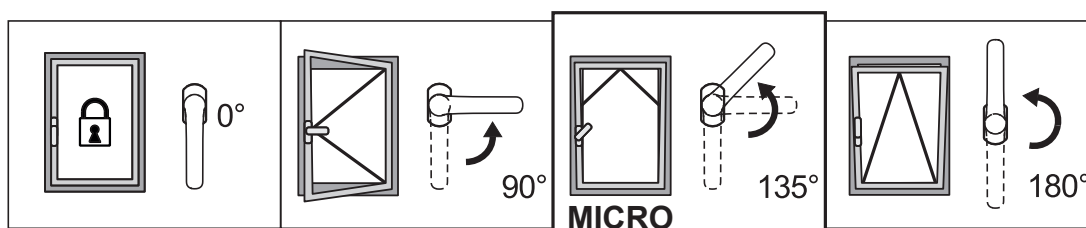

Production micro-ventilation with Logica opening

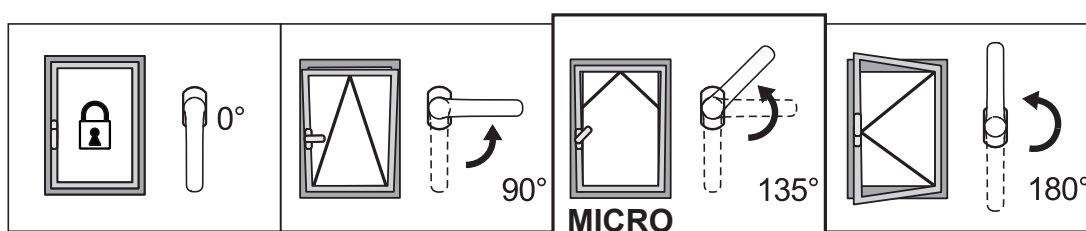

## ADJUSTMENTS [mm]

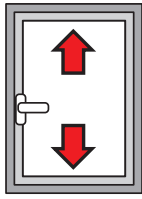

**Height:**  
+2.5 / -1

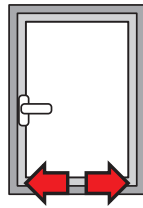

**Side:**  
±1.5

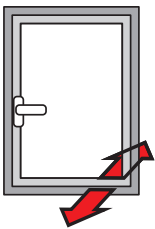

**Bottom hinge compression:**  
+1.4 / -0.6

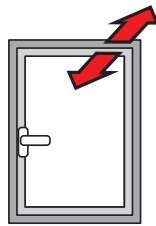

**Top hinge compression:**  
±1.5

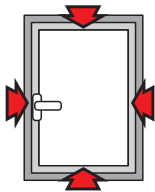

**Striker compression:**  
±1.8

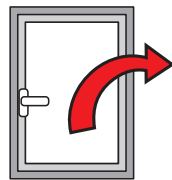

**Sash fall:**  
+3.5 / -1.5

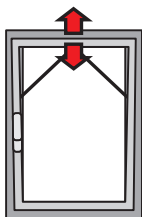

**Micro-ventilation:**  
+3.6 / -1.8

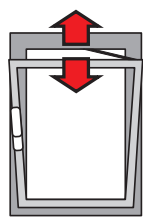

**T2 arm opening:**  
148 ÷ 178

Table of maximum glass thickness [mm]

2800	40	33	29	25	22	20	18	17	15	14			
2700	42	35	30	26	23	21	19	18	16	15			
2600	45	37	32	28	25	22	20	19	17	16	15		
2500	49	41	35	31	27	25	22	20	19	18	16	15	
2400	49	41	35	31	27	25	22	20	19	18	16	15	
2300	51	43	37	32	28	26	23	21	20	18	17	16	
2200	54	45	38	33	30	27	24	22	21	19	18	17	
2100	56	47	40	35	31	28	25	23	22	20	19	18	
2000	59	49	42	37	33	29	27	25	23	21	20	18	
1900	60	52	44	39	34	31	28	26	24	22	21	19	
1800	60	55	47	41	36	33	30	27	25	23	22	20	
1700	60	58	49	43	38	35	31	29	27	25	23	20	
1600	60	60	53	46	41	37	33	31	28	26	23	20	
1500	60	60	56	49	44	39	36	33	30	26	23	20	
1400	60	60	60	53	47	42	38	35	30	26	23	20	
1300	60	60	60	57	50	45	41	35	30	26	23	20	
1200	60	60	60	60	55	49	42	35	30	26	23		
1100	60	60	60	60	59	51	42	35	30	26			
1000	60	60	60	60	60	51	42	35	30				
900	60	60	60	60	60	51	42	35					
800	60	60	60	60	60	51	42						
700	60	60	60	60	60	51							
600	470	500	600	700	800	900	1000	1100	1200	1300	1400	1500	1600

Table of maximum load capacity [kg]

2800	143	143	143	143	143	143	143	143	143	143			
2700	145	145	145	145	145	145	145	145	145	145			
2600	148	148	148	148	148	148	148	148	148	148	148		
2500	150	150	150	150	150	150	150	150	150	150	150	150	
2400	150	150	150	150	150	150	150	150	150	150	150	150	
2300	150	150	150	150	150	150	150	150	150	150	150	150	
2200	150	150	150	150	150	150	150	150	150	150	150	150	
2100	150	150	150	150	150	150	150	150	150	150	150	150	
2000	150	150	150	150	150	150	150	150	150	150	150	150	
1900	150	150	150	150	150	150	150	150	150	150	150	150	
1800	150	150	150	150	150	150	150	150	150	150	150	146	
1700	150	150	150	150	150	150	150	150	150	150	147	138	
1600	150	150	150	150	150	150	150	150	150	148	138	130	
1500	150	150	150	150	150	150	150	150	150	139	130	122	
1400	150	150	150	150	150	150	150	150	140	130	121	113	
1300	150	150	150	150	150	150	150	140	130	120	112	105	
1200	150	150	150	150	150	150	141	130	120	111	104		
1100	150	150	150	150	150	143	130	119	110	102			
1000	150	150	150	150	144	130	118	108	100				
900	150	150	150	146	130	117	106	97					
800	150	150	148	130	115	104	94						
700	150	150	130	113	101	91							
600	470	500	600	700	800	900	1000	1100	1200	1300	1400	1500	1600

# CHIC 150

## CHIC 3D 150 standard

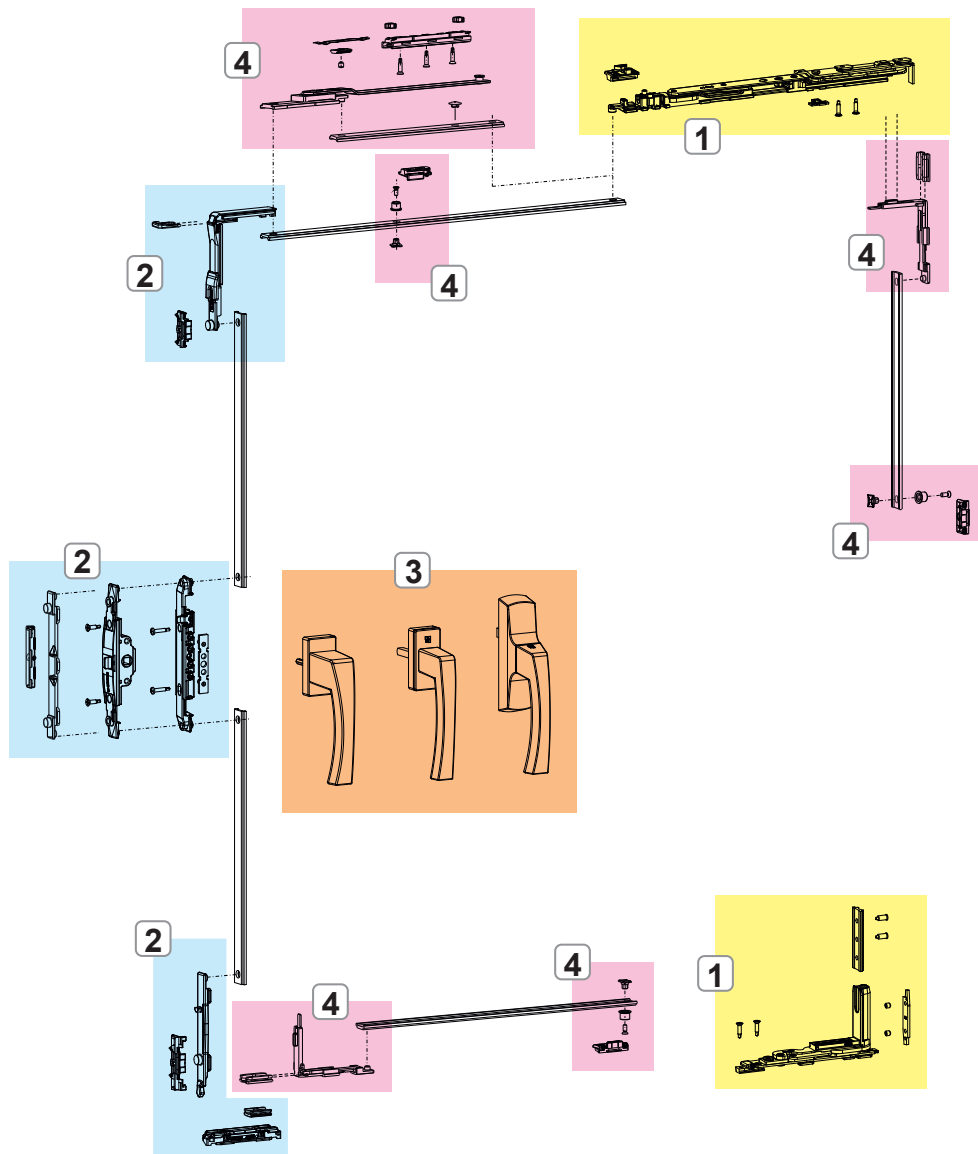

1. CHIC 3D 150 HINGES AND ARMS
2. CHIC 3D 150 FASTENING MECHANISMS
3. NP SUPRA CREMONES, WINDOW HANDLES AND MECHANISMS
4. CHIC 3D 150 ADDITIONAL FASTENING MECHANISMS AND HARDWARE

# CHIC 150

## CHIC 3D 150 logica

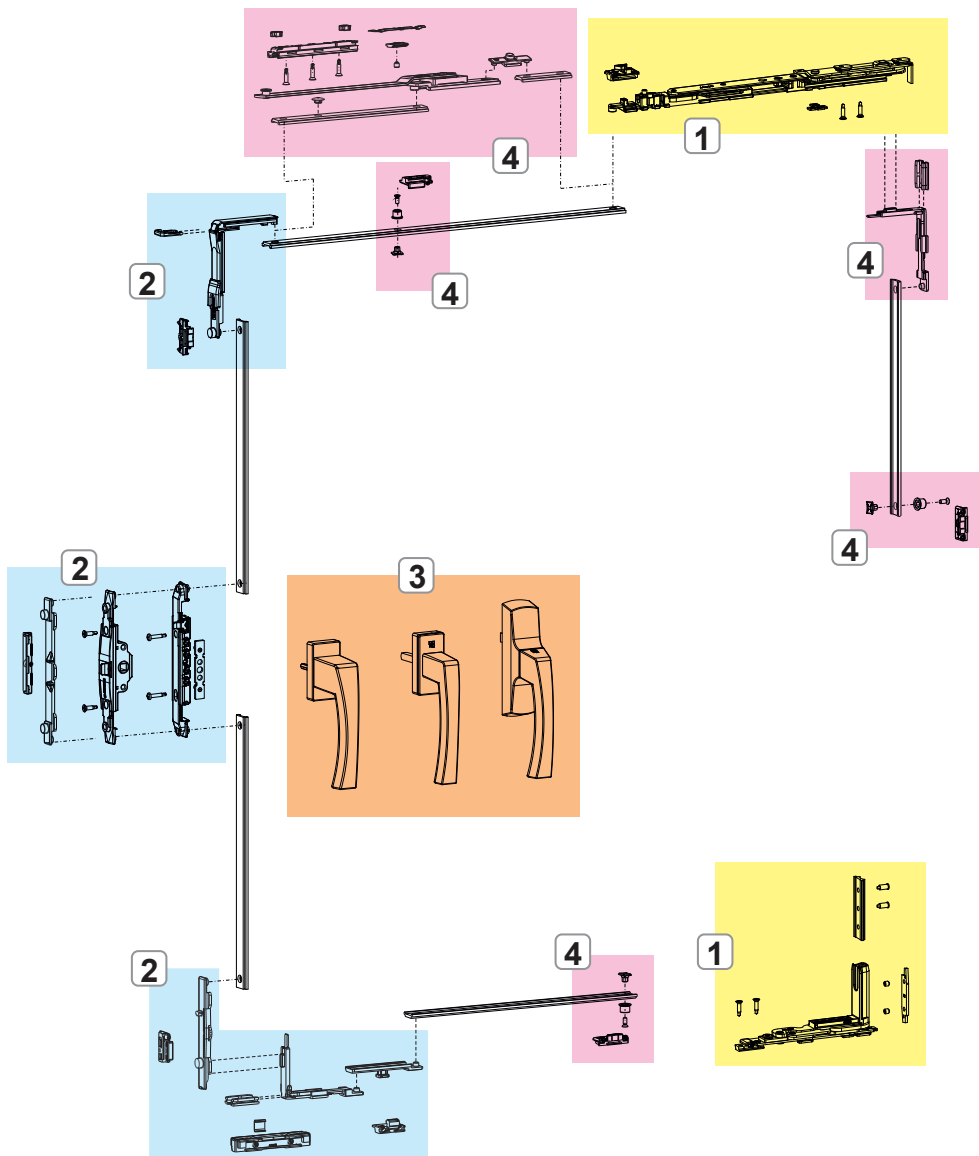

- 1. CHIC 3D 150 HINGES AND ARMS
- 2. CHIC 3D 150 FASTENING MECHANISMS
- 3. NP SUPRA CREMONES, WINDOW HANDLES AND MECHANISMS
- 4. CHIC 3D 150 ADDITIONAL FASTENING MECHANISMS AND HARDWARE

## CHIC 3D 150 HINGES AND ARMS

### Functions

Set of hinges (top and bottom), completely pre-assembled and ready to be installed on the profile.

### Technical Features

They enable tilt-and-turn opening combined with the mechanisms.

Available in right- and left-hand versions.

Micro-ventilation and logica versions.

The arm is equipped with micro-ventilation as standard (adjustable).

Moving the fastening pawl takes the arm from conventional to logica.

The T2 arm is adjustable: the opening "A" goes from 178 mm (base) to 148 mm.

### Materials

Corner support made of zamak

Connecting brackets and hinge plates made of zinc plated steel

Pins made of 304 grade stainless steel and aluminium bronze

Cams made of zinc plated steel

Connecting bracket and arm rod made of 304 grade stainless steel

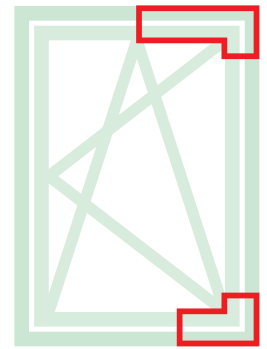

Online data sheet



0436521

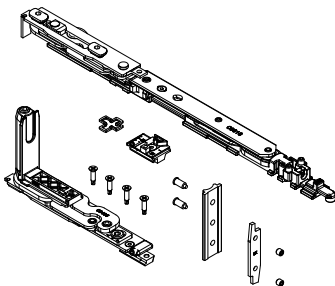

0436511

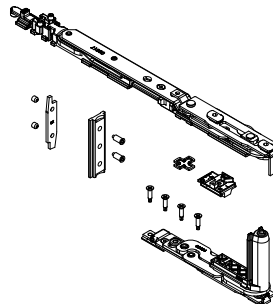

0436621

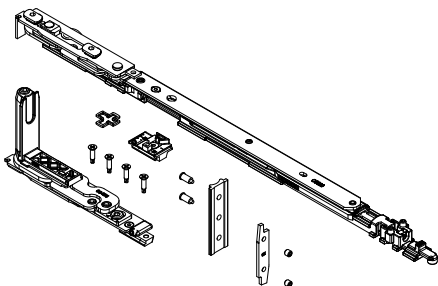

0436611

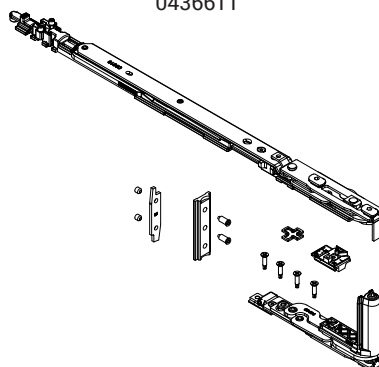

Sash opening



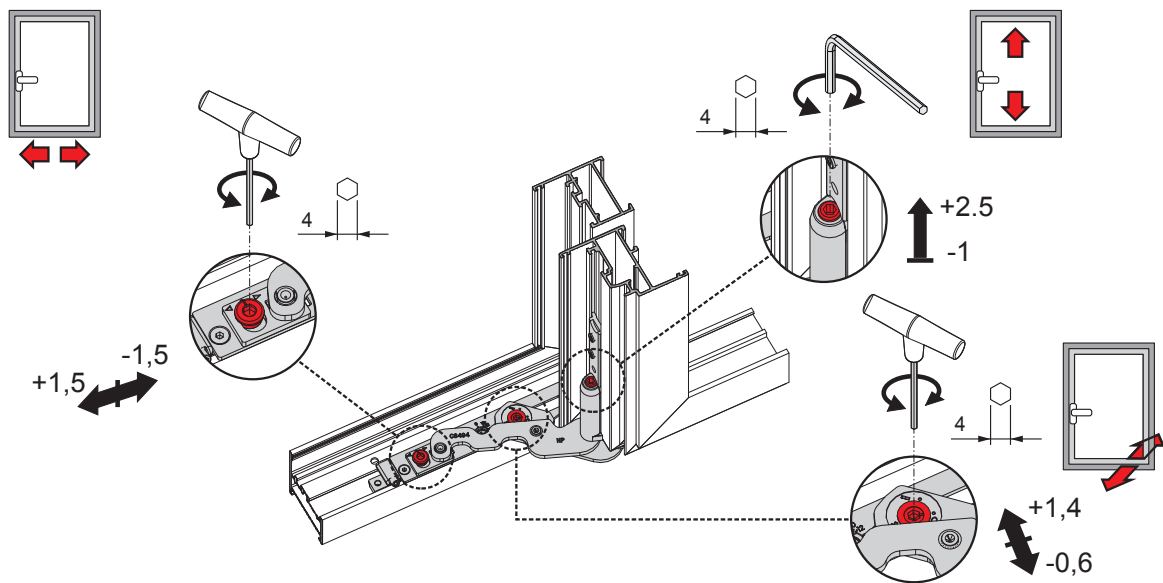
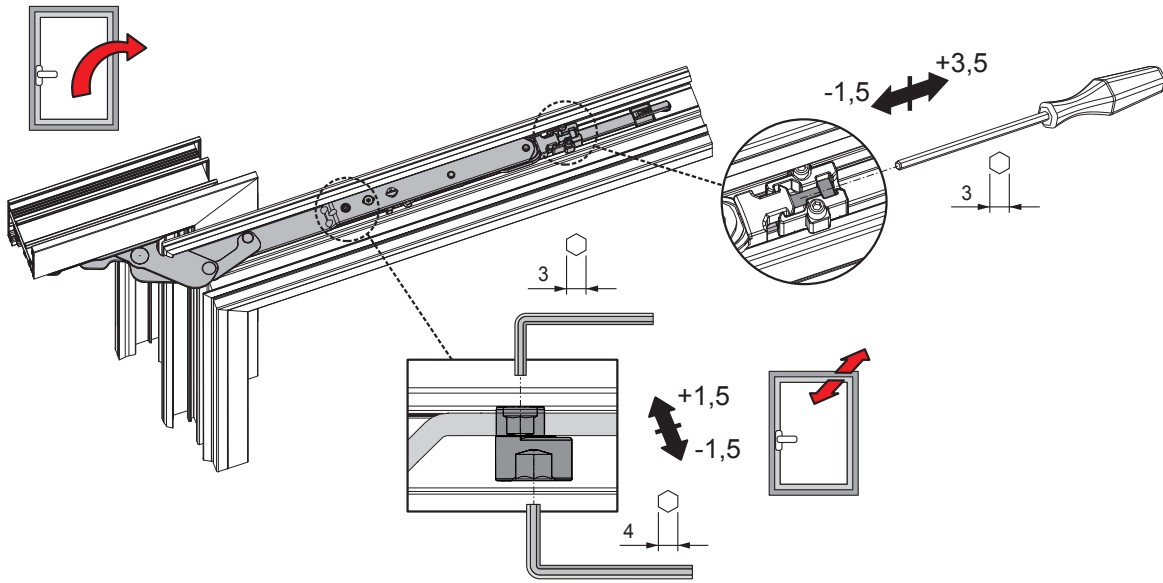

Item code	Description	PROFILE CROSS - SECTION	Range (mm)	Version	A (mm)	Hand	Base Raw	Anodised Elox	Painted	Trend/Gold Brass	Pieces per pack
0436511	CHIC 150 - T1 ARM T&T KIT	C001-C002-C003-C004-C005-C006	L 470 ÷ 700	Micro	-	RX	X				10
0436521	CHIC 150 - T1 ARM T&T KIT	C001-C002-C003-C004-C005-C006	L 470 ÷ 700	Micro	-	LX	X				10
0436611	CHIC 150 - T2 ARM T&T KIT	C001-C002-C003-C004-C005-C006	L 600 ÷ 1600	Micro	148÷178	RX	X				10
0436621	CHIC 150 - T2 ARM T&T KIT	C001-C002-C003-C004-C005-C006	L 600 ÷ 1600	Micro	148÷178	LX	X				10

## CHIC 3D 150 FASTENING MECHANISMS

### Functions

Tilt-and-Turn fastening mechanisms for cremone, window handle and NP SUPRA window handle, available in the Standard and Logica versions.

### Materials

Drive, drive rod, mechanism bolt tip and strikers in zamak with GS Silver Plus finish (up to 500 h of corrosion resistance).

Screws and grub screws in stainless steel.

Polyamide raiser.

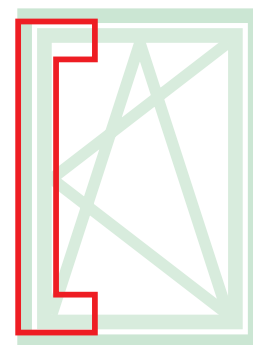

Online data sheet

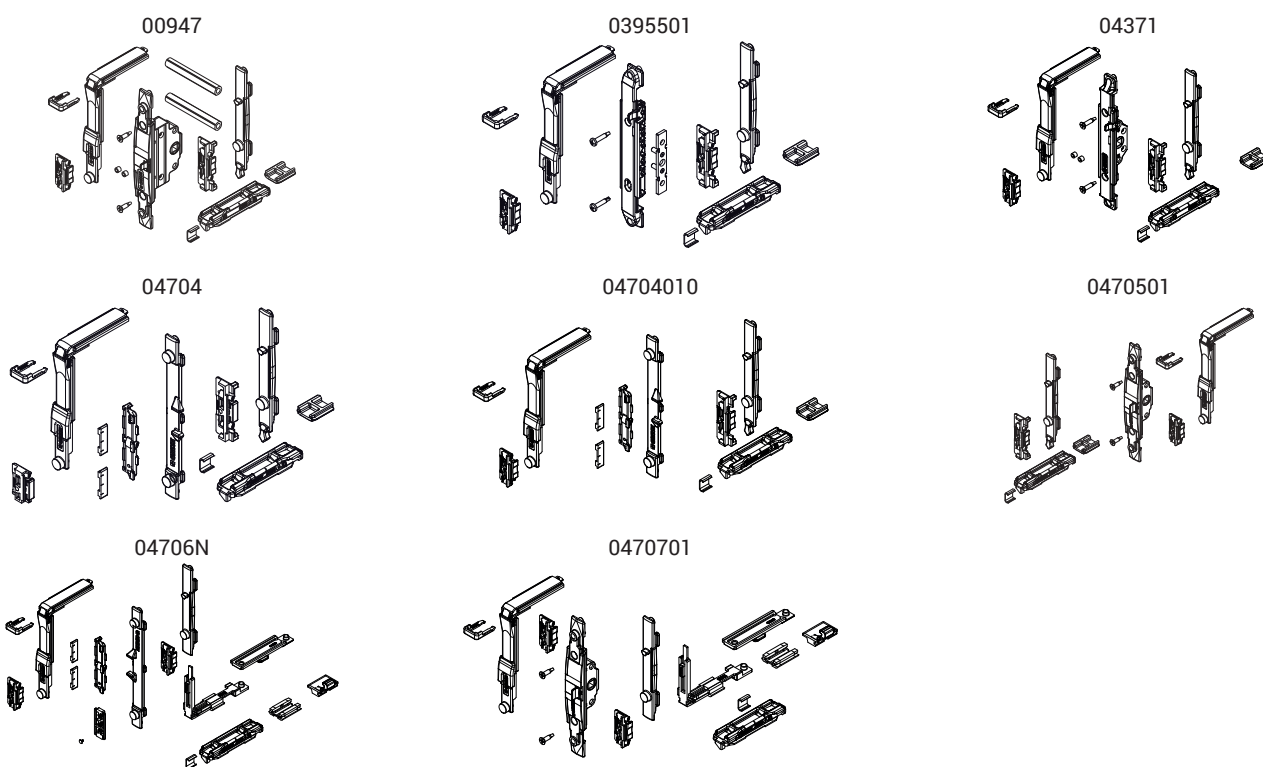

Item code	Description	PROFILE CROSS - SECTION	Mechanism	Version	Base Raw	Anodised Elox	Painted	Trend/Gold Brass	Pieces per pack
00947	T/T M 180 MOVEMENT FASTENING MECHANISM	C001-C002-C003-C005-C006-C013-C014-C015-C017	Window handle	-	X				10
0395501	T/T FASTENING MECHANISM	C001-C002-C003-C005-C006-C013-C014-C015-C017	NP SUPRA	-	X				10
04371	FASTENING MECHANISM T/T MOVEMENT M 180	C001-C002-C004-C005-C006-C013-C014-C015-C016-C017	Window handle - SUPRA 7	-	X				10
04704	T/T FASTENING MECHANISM	C001-C002-C003-C005-C006-C013-C014-C015-C016-C017	Cremone	-	X				10
04704010	T/T FASTENING MECHANISM	C001-C003	Cremone	-	X				10
0470501	T/T M 180 FASTENING MECHANISM	C001-C002-C004-C005-C006-C013-C014-C015-C016-C017	Window handle - SUPRA 7	-	X				10
04706N	T/T LOGICA FASTENING MECHANISM	C001-C002-C003-C005-C006-C013-C014-C015-C016-C017	Cremone	Logica	X				10
0470701	T/T M 180 LOGICA FASTENING MECHANISM	C001-C002-C004-C005-C006-C013-C014-C015-C016-C017	Window handle	Logica	X				10

## CHIC 3D 150 ADDITIONAL FASTENING MECHANISMS AND ACCESSORIES

### Functions

The additional fasteners make it possible to add further fastening elements that either increase the dimensions of the casement or that can be used when locking points are needed on the cross beams or hinge-side upright.

### Technical Features

On the basis of the dimensions of the casement, additional fasteners (for  $H > 1200$  mm and  $W > 1000$  mm) and the additional arm (which is mandatory for  $W > 1000$  mm) are to be used in combination with this mechanism.

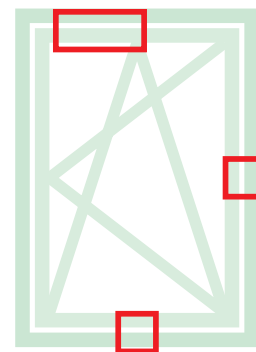

Online data sheet



02030K

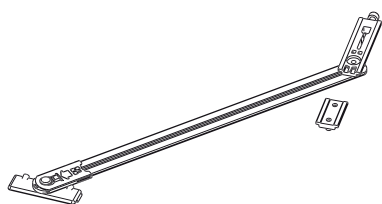

03535

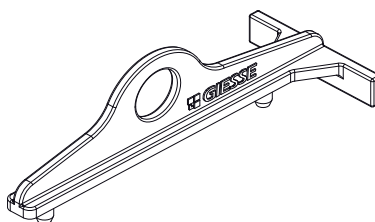

04024K

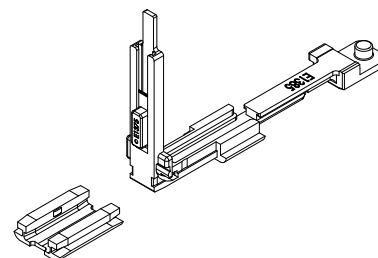

04301K

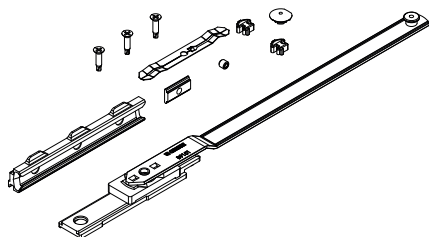

04357

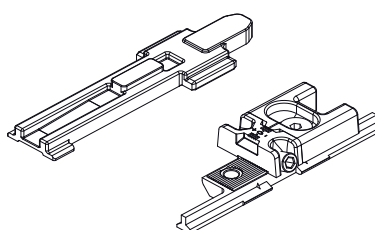

04770K

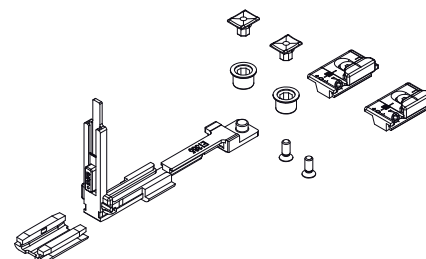

04777K

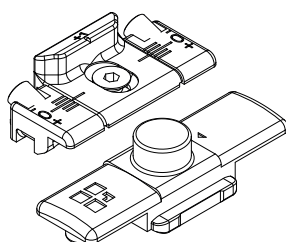



Mandatory to use the FRIZ arm

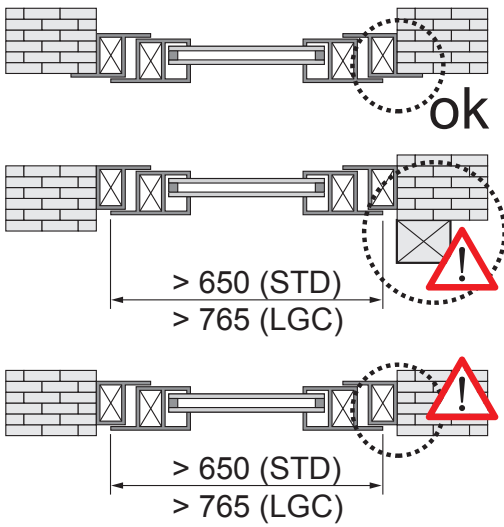

FRIZ arm positioning

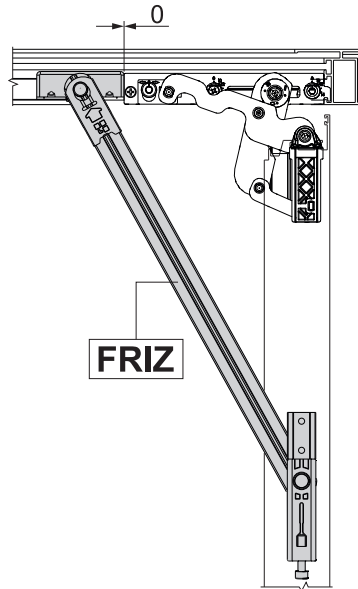

Opening angle with FRIZ arm

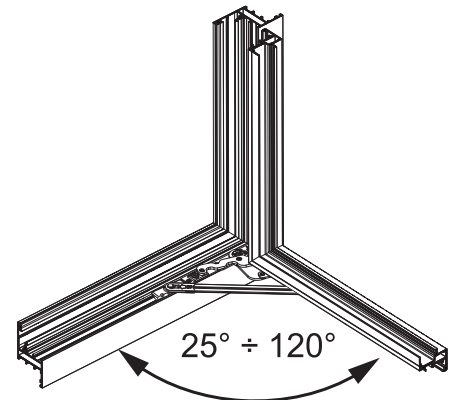

Item code	Description	PROFILE CROSS - SECTION	Range (mm)	Version	Base Raw	Anodised Elox	Painted	Trend/Gold Brass	Pieces per pack
02030K	FRIZ STAY LIMITATION ARM	C001-C002-005-C011-C013-C014-C015-C016-C017	See picture	-	X				10
03535	CHIC - TEMPLATE FOR TILT-AND-TURN	C001-C002-C003-C005-C006	-	-	X				10
04024K	CORNER DRIVE FOR FUTURA BURGLAR-PROOF FUNCTION	C001-C002-C003-C013-C014-C015-C016-C017	-	-	X				10
04301K	T/T FUTURA ADDITIONAL ARM	C001-C002-C003-C005-C006-C011-C013-C014-C015-C016-C017	W > 1000	-	X				5
04357	CHIC - ARM ADDITIONAL FASTENING MECHANISM	C001-C002-C003-C005-C006	-	-	X				10
04770K	FUTURA ADDITIONAL FASTENING MECHANISM	C001-C002-C003-C005-C006-C013-C014-C015-C016-C017	H > 1200 L > 1000	-	X				10
04777K	FUTURA ADDITIONAL FASTENING MECHANISM	C001-C002-C003-C005-C006-C011-C013-C014-C015-C016-C017	H > 1200 L > 1000	Logica	X				50

## SECONDARY SASH HINGE SET FOR CHIC 3D 150

### Functions

Set of hinges (top and bottom) for side-hung or secondary sash with tilt-and-turn CHIC 3D 150.

### Technical Features

Sash opening to 180°.

Maximum load capacity 150 kg.

Assembly is simple, fast and easy using the special pre-assembled cams.

When there is an additional fastening mechanism, you need to use the CHIC fastening element.

Both hinges are adjustable (3D).

If opening is obstructed, you need to use the FRIZ limitation arm.

**CAUTION:** This hinge is designed to be used only on inward opening casements and is not suitable for outward opening casements.

### Materials

Corner support made of zamak

Connecting brackets and hinge plates made of zinc plated steel

Pins made of 304 grade stainless steel and aluminium bronze

Cams made of zinc plated steel

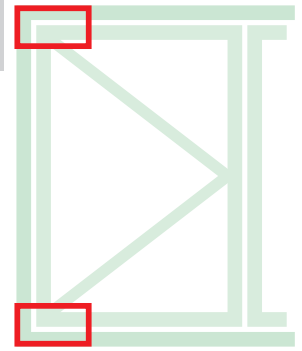

Online data sheet



0436421

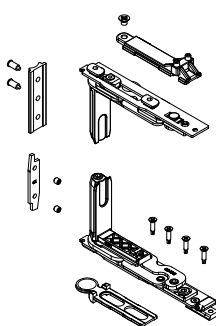

0436411

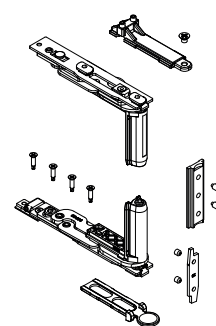

Mandatory to use the FRIZ arm

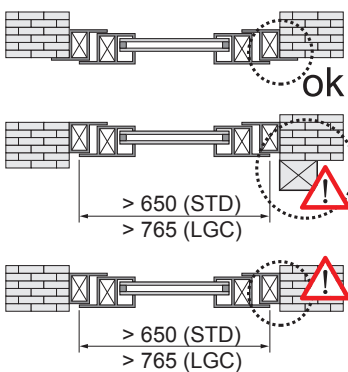

FRIZ arm positioning

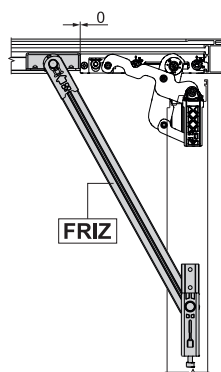

Opening angle with FRIZ arm

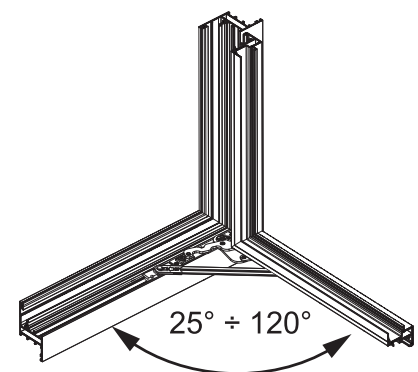

Item code	Description	PROFILE CROSS - SECTION	Hand	Base Raw	Anodised Elox	Painted	Trend/Gold Brass	Pieces per pack
0436411	CHIC - SASH HINGE SET	C001-C002-C003-C004-C005-C006	RX	X				10
0436421	CHIC - SASH HINGE SET	C001-C002-C003-C004-C005-C006	LX	X				10